

INDEX OF SHEETS

1. COVER SHEET, STANDARDS, & SUMMARY OF QUANTITIES
2. PROPOSED TYPICAL CROSS SECTION SN 053-3026
3. PROPOSED TYPICAL CROSS SECTION SN 053-3027, 053-3028 & 053-3029

**PROPOSED STRUCTURE OVERLAYS FOR
SN 053-3026, 053-3027, 053-3028 & 053-3029**

F.A.S. ROUTE 1362, CH 8,
1200N RD (OCOYA RD)
SECTION 22-00100-04-SM

NON-MFT

R 4 E, 3rd PM

HIGHWAY STANDARDS

- 701301-04 LANE CLOSURE 2L, 2W SHORT TIME OPERATIONS
- 701306-04 LANE CLOSURE 2L, 2W SLOW MOVING OPERATIONS DAY ONLY ≥ 45MPH
- 701311-03 LANE CLOSURE 2L, 2W MOVING OPERATIONS DAY ONLY
- 701901-08 TRAFFIC CONTROL DEVICES
- BLR 21-9 TYPICAL APPLICATION OF TRAFFIC CONTROL DEVICES FOR CONSTRUCTION ON RURAL LOCAL HIGHWAYS
- BLR 22-7 TYPICAL APPLICATION OF TRAFFIC CONTROL DEVICES FOR CONSTRUCTION ON RURAL LOCAL HIGHWAYS (TWO-LANE TWO WAY RURAL TRAFFIC) (ROAD CLOSED TO THRU TRAFFIC)

SUMMARY OF QUANTITIES

ITEM NO.	ITEM	UNIT	TOTAL QUANTITIES
40600290	BITUMINOUS MATERIALS (TACK COAT)	POUND	2,027
40604000	HOT-MIX ASPHALT SURFACE COURSE, IL-9.5FG, MIX "C", N50	TON	403
44000157	HOT-MIX ASPHALT SURFACE REMOVAL, 2"	SQ YD	304
58100200	WATERPROOFING MEMBRANE SYSTEM	SQ YD	464
* X4401198	HOT-MIX ASPHALT SURFACE REMOVAL, VARIABLE DEPTH	SQ YD	1,061
* X4420486	CLASS D PATCHES, TYPE IV, 6 INCH (SPECIAL)	SQ YD	31
* X7010216	TRAFFIC CONTROL AND PROTECTION, (SPECIAL)	L SUM	1

* SEE SPECIAL PROVISIONS

ADDENDUM 1

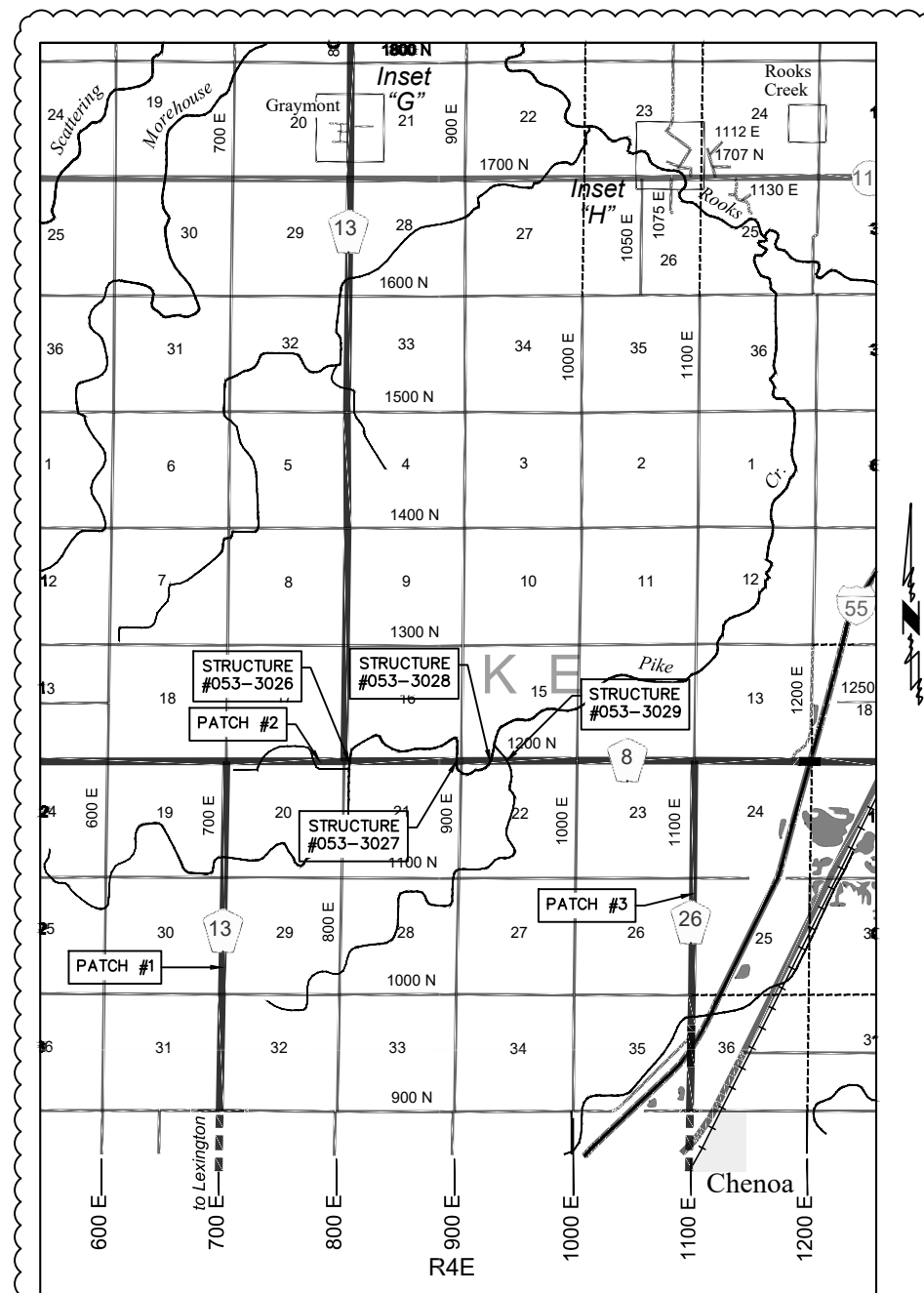

LIVINGSTON COUNTY GROSS LENGTH = 1,527' = 0.30 MILES
LIVINGSTON COUNTY NET LENGTH = 1,527' = 0.30 MILES

ADDENDUM 1

ROUTE NO.	SECTION	COUNTY	TOTAL SHEETS	SHEET NO.
1362	22-00100-04-SM	LIVINGSTON	3	1
PROJECT NO. ----		CONTRACT NO. ----		

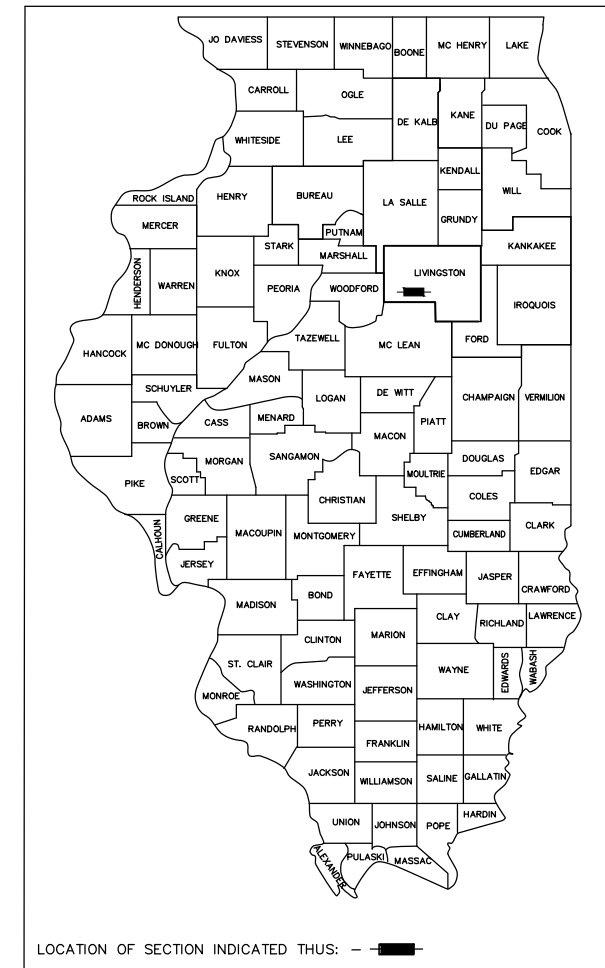

LOCATION OF SECTION INDICATED THUS: - - - -

LIVINGSTON COUNTY: THIS PROJECT CONSISTS OF OVERLAYING EXISTING STRUCTURES ALONG CH 8 (1200N RD). INCLUDES THE OVERLAY OF STRUCTURES 053-3026, 053-3027, 053-3028 & 053-3029 LOCATED ALONG 1200N RD BETWEEN 800E RD AND 1000E RD & THREE HMA PATCHES ON 700E, 1200N & 1100E.

UTILITIES

CONTACT J.U.L.I.E. 811 or 800-892-0123 BEFORE DIGGING

TRAFFIC DATA

C.H. 8 - COLLECTOR
POSTED SPEED = 55 MPH-RURAL
DESIGN SPEED = 50 MPH-RURAL
CURRENT ADT= 350
CLASS III ROADS, 80,000#



THESE PLANS WERE MADE BY ME OR BY A MEMBER OF MY STAFF WORKING UNDER MY PERSONAL SUPERVISION.

05/05/2023
DATE

TRENT RUESTMAN, P.E.
NO. 062.068070
EXPIRATION DATE 11/30/23

CONTRACT NO. ----

"THE ACCEPTANCE OF THIS PROJECT IS BASED ON THE MINIMUM DESIGN CRITERIA UNDER 3R GUIDELINES."

APPROVED 05/05 20 23

Clay Mitchell
LIVINGSTON COUNTY OFFICIAL

PASSED _____ 20 _____

DISTRICT THREE LOCAL ROADS & STREETS ENGINEER

RELEASING FOR BID BASED ON LIMITED REVIEW _____ 20 _____

REGION TWO ENGINEER
STATE OF ILLINOIS
DEPARTMENT OF TRANSPORTATION

NOT PLOTTED TO SCALE

ROUTE NO.	SECTION	COUNTY	TOTAL SHEETS	SHEET NO.
1362	22-00100-04-SM	LIVINGSTON	3	2
PROJECT NO. ----		CONTRACT NO. ----		

BITUMINOUS MIX TABLE

Mixture Use(s)	HMA Surface
Location(s)	ENTIRE PROJECT
PG Grade	PG64-22
Design Air Voids	4.0% @ N50
Mixture Composition	IL 9.5FG
Friction Aggregate	Mixture C
Density Test Method	Satisfaction of Engineer
Mixture Weight	112 # / s.y. / inch
Quality Management Program	QC/QA
Sublot Size	N/A
Material Transfer Device	NO

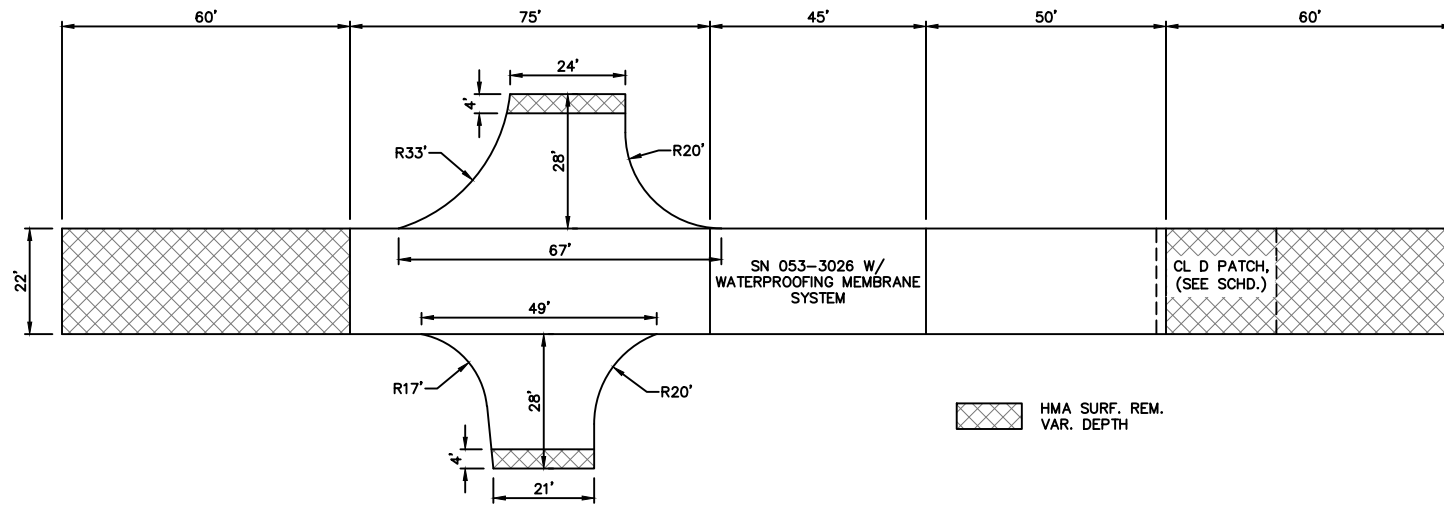

PLAN SN 053-3026

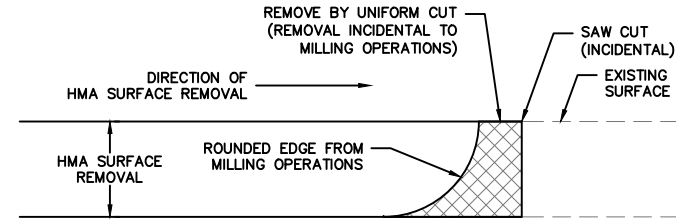

NOTE: WHEN MILLING OPERATIONS PRODUCE A ROUNDED EDGE, THEN A SAW CUT SHALL BE USED TO MANUFACTURE A PERPENDICULAR EDGE AS SHOWN IN THE DETAIL. THE ENGINEER SHALL BE THE SOLE JUDGE CONCERNING THE USE OF THIS DETAIL.

HMA DETAIL AT BUTT JOINTS

OCOYA RD / CH 8 - CLASS D PATCH QUANTITIES				
Sta.	Lane	LENGTH (FT)	WIDTH (FT)	AREA (SQ YD)
Sta. 478+80 to Sta. 479+05	WBL	25	11	31
TOTALS				31

OCOYA RD / CH 8 - INTERSECTION/SIDEROAD QUANTITIES				
LOCATION	AREA (SQ YD)	HMA SURF REM VAR DEPTH (S.Y.)	BIT. MAT. (TACK COAT) (LB)	SURFACE COURSE
800E (R)	105	11	47	9
800E (L)	82	9	37	7
900E (R)	98	10	44	8
900E (L)	99	10	45	8
PE Sta. 495+91 (R)	55	12	25	5
TOTALS		52	198	37

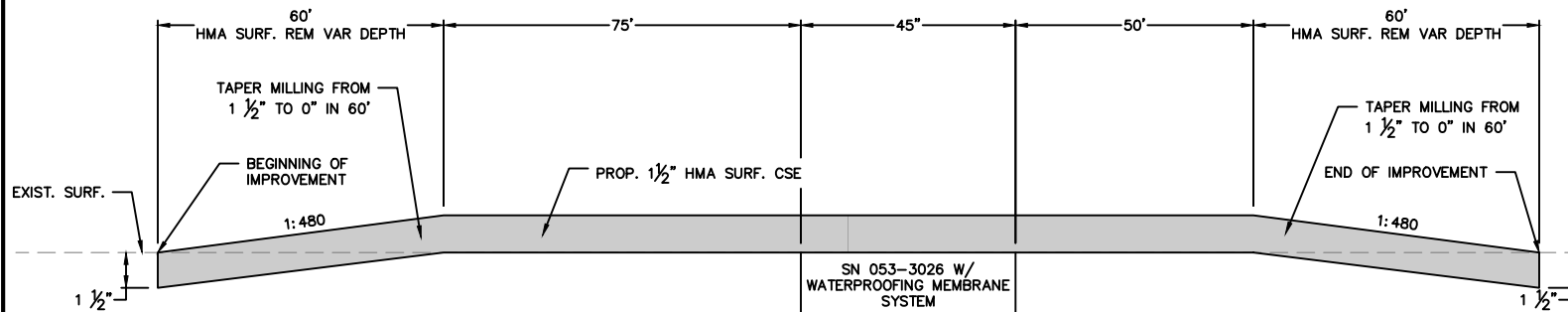

SECTION SN 053-3026

BEGINNING & END OF IMPROVEMENTS (NTS)

ADDENDUM 1

SCHEDULE OF RESURFACING QUANTITIES

Unit weight Constant = 112.0 lbs./s.y./inch

LOCATION (QUANTITY)	LENGTH	Paving width	HMA SURF REMOVAL VAR DEPTH (SQ YD)	WATERPROF MEMBRANE SYSTEM (SQ YD)	BIT MATLS TACK CT (POUND)	HMA SURF REMOVAL 2" (SQ YD)	HMA SURF CSE "C" N50 (TON)
MAINLINE							
425+96.5 to 426+56.5 (TAPER)	60.0	22.0	147	-	66	-	12
426+56.5 to 427+31.5	75.0	22.0	-	-	82	-	15
427+31.5 to 427+76.5 (SN 053-3026)	45.0	24.0	-	120	27	-	10
427+76.5 to 428+26.5	50.0	22.0	-	-	55	-	10
428+26.5 to 428+86.5 (TAPER)	60.0	22.0	147	-	66	-	12
478+17.5 to 478+77.5 (TAPER)	60.0	22.0	147	-	66	-	12
478+77.5 to 479+27.5	50.0	22.0	-	-	55	-	10
479+27.5 to 479+72. (SN 053-3027)	44.5	24.0	-	119	27	-	10
479+72. to 480+84.	112.0	22.0	-	-	123	-	23
480+84. to 481+44. (TAPER)	60.0	22.0	147	-	66	-	12
492+99.1 to 493+59.1 (TAPER)	60.0	22.0	147	-	66	-	12
493+59.1 to 494+09.1	50.0	22.0	-	-	55	-	10
494+09.1 to 494+53.1 (SN 053-3028)	44.0	24.0	-	117	26	-	10
494+53.1 to 500+59.1	606.0	22.0	-	-	666	-	124
500+59.1 to 500+99.6 (SN 053-3029)	40.5	24.0	-	108	24	-	9
500+99.6 to 501+49.6	50.0	22.0	-	-	55	-	10
501+49.6 to 502+09.6 (TAPER)	60.0	22.0	147	-	66	-	12
PATCH #1 1015N, 700E RD	10.0	21.0	23	-	10	-	2
	25.0	21.0	-	-	26	-	5
	25.0	21.0	58	-	26	-	5
PATCH #2 779E, 1200N RD	238.0	11.5	-	-	137	304	34
PATCH #3 1083N, 1100E RD	10.0	21.0	23	-	10	-	2
	15.0	21.0	-	-	16	-	3
	10.0	21.0	23	-	10	-	2
TOTAL JOB LENGTH OR MAINLINE QUANTITY	1860		1009	464	1829	304	366
MISCELLANEOUS							
SIDEROAD INTERSECTIONS/ENTRANCES (3)	-		52	-	198	-	37
TOTALS OF MAINLINE & MISC.	1,860		1,061	464	2,027	304	403

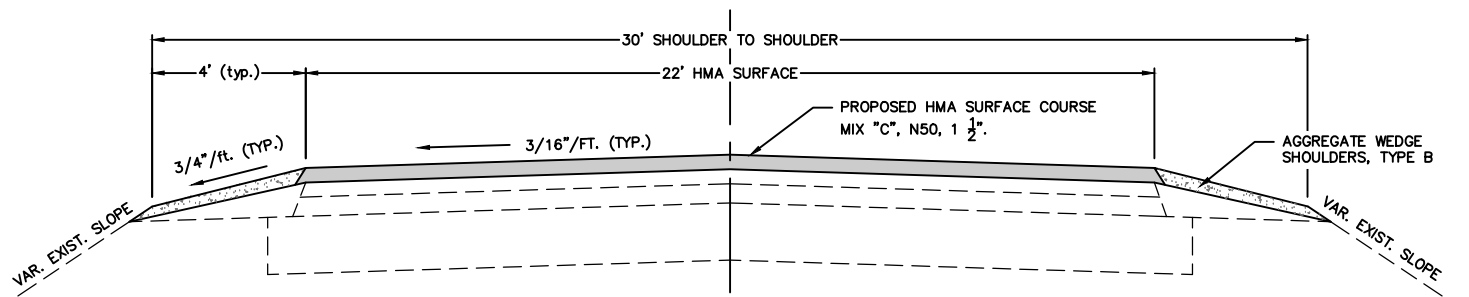

PROPOSED TYPICAL CROSS SECTION (NTS)

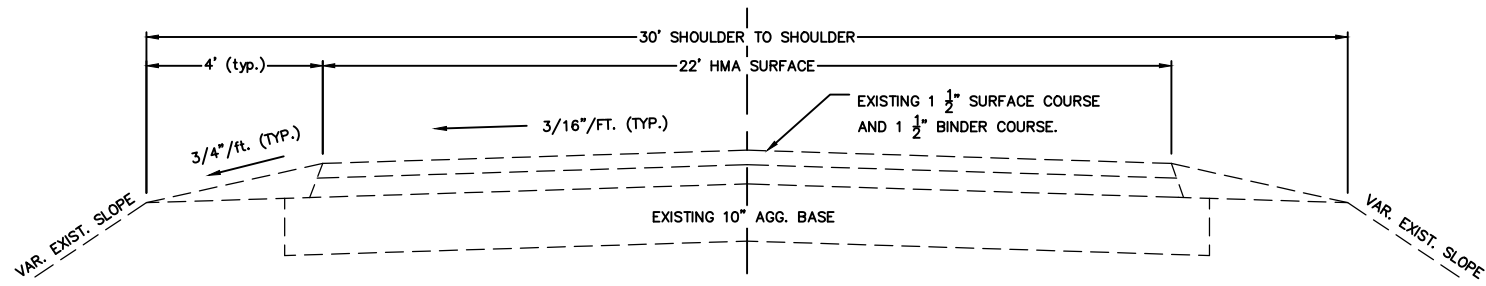

EXISTING TYPICAL CROSS SECTION (NTS)

NOT PLOTTED TO SCALE

ROUTE NO.	SECTION	COUNTY	TOTAL SHEETS	SHEET NO.
1362	22-00100-04-SM	LIVINGSTON	3	3
PROJECT NO. ----		CONTRACT NO. ----		

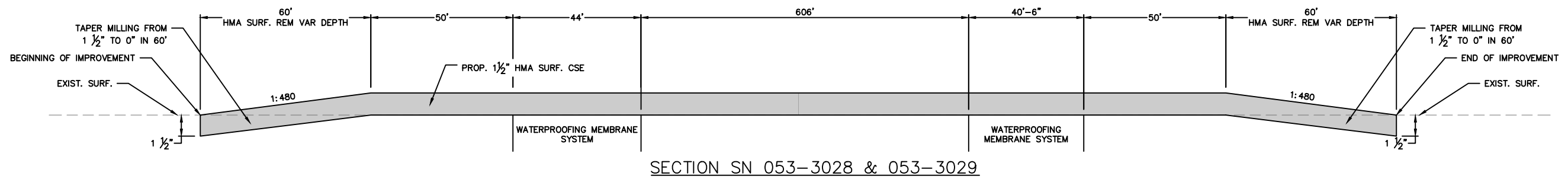
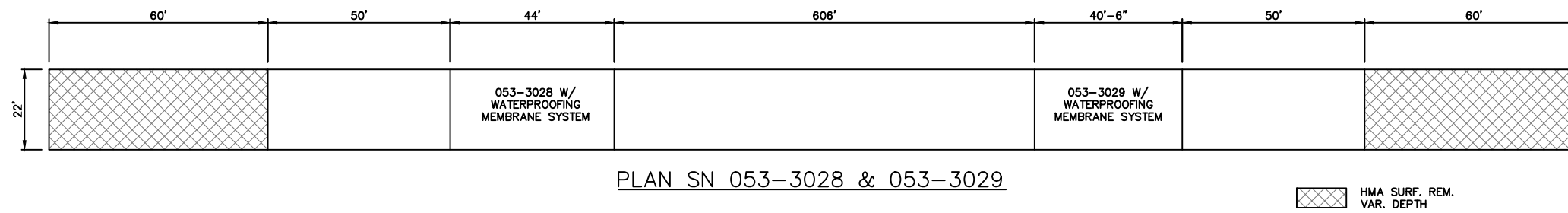
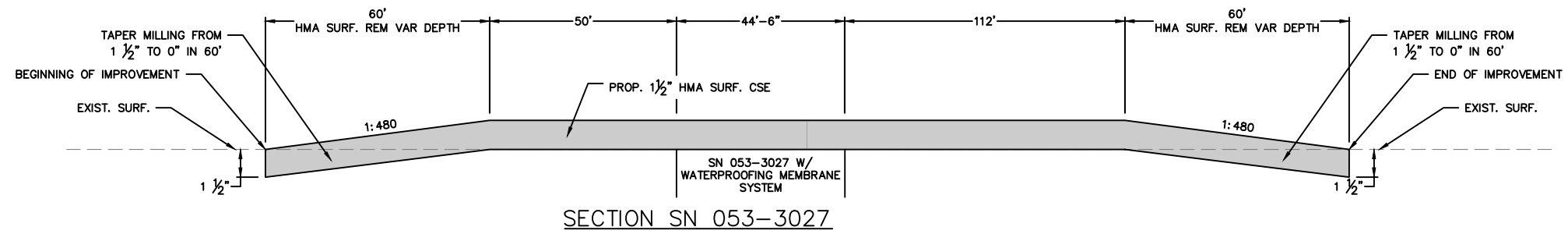
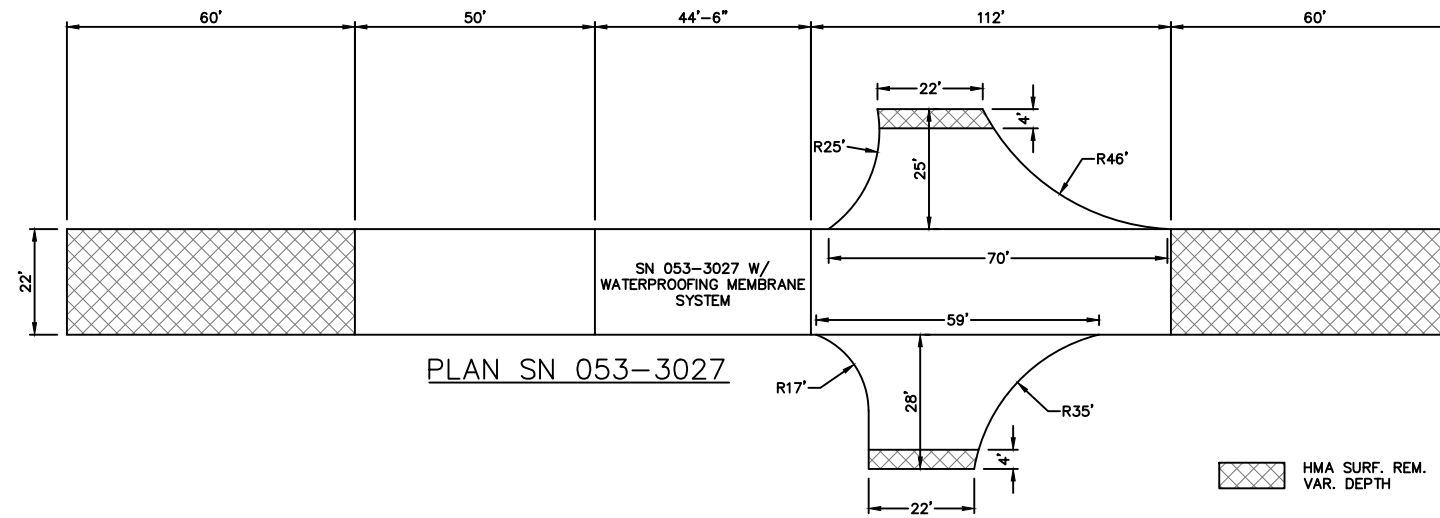

BEGINNING & END OF IMPROVEMENTS (NTS)