

# LIVINGSTON COUNTY HIGHWAY DEPARTMENT

---

Clay A. Metcalf, P.E., *County Engineer*  
Trent C. Ruestman, P.E., Assist County Engineer

1705 S. Manlove Street  
Pontiac, Illinois 61764

Ph. (815) 842-1184  
FAX (815) 842-3305

## **Addendum #1 – June 1, 2023**

### **Livingston County Highway Department**

#### **Section 22-00100-04-SM**

Summary of Changes: Added 3 patch locations on 700E Rd, 1200N Rd and 1100E Rd to the bid documents.

1. Replace Page 1 of the plans with the attached Page 1.
2. Replace Page 2 of the plans with the attached Page 2.
3. Replace the Schedule of Prices on Page 7 or the proposal with the attached Schedule of Prices.  
(Note: The electronic Schedule of Prices should be used)

The Plans, Proposal and Schedule of Prices documents have been updated on the website to include the revisions.

**NOTE: Read receipt or email response will confirm addendum received.**

**INDEX OF SHEETS**

1. COVER SHEET, STANDARDS, & SUMMARY OF QUANTITIES
2. PROPOSED TYPICAL CROSS SECTION SN 053-3026
3. PROPOSED TYPICAL CROSS SECTION SN 053-3027, 053-3028 & 053-3029

**PROPOSED STRUCTURE OVERLAYS FOR  
SN 053-3026, 053-3027, 053-3028 & 053-3029**

F.A.S. ROUTE 1362, CH 8,  
1200N RD (OCOYA RD)  
SECTION 22-00100-04-SM

**NON-MFT**

R 4 E, 3rd PM

ROUTE NO.	SECTION	COUNTY	TOTAL SHEETS	SHEET NO.
1362	22-00100-04-SM	LIVINGSTON	3	1
PROJECT NO. ----		CONTRACT NO. ----		

**HIGHWAY STANDARDS**

- 701301-04 LANE CLOSURE 2L, 2W SHORT TIME OPERATIONS
- 701306-04 LANE CLOSURE 2L, 2W SLOW MOVING OPERATIONS DAY ONLY ≥ 45MPH
- 701311-03 LANE CLOSURE 2L, 2W MOVING OPERATIONS DAY ONLY
- 701901-08 TRAFFIC CONTROL DEVICES
- BLR 21-9 TYPICAL APPLICATION OF TRAFFIC CONTROL DEVICES FOR CONSTRUCTION ON RURAL LOCAL HIGHWAYS
- BLR 22-7 TYPICAL APPLICATION OF TRAFFIC CONTROL DEVICES FOR CONSTRUCTION ON RURAL LOCAL HIGHWAYS (TWO-LANE TWO WAY RURAL TRAFFIC) (ROAD CLOSED TO THRU TRAFFIC)

**SUMMARY OF QUANTITIES**

ITEM NO.	ITEM	UNIT	TOTAL QUANTITIES
40600290	BITUMINOUS MATERIALS (TACK COAT)	POUND	2,027
40604000	HOT-MIX ASPHALT SURFACE COURSE, IL-9.5FG, MIX "C", N50	TON	403
44000157	HOT-MIX ASPHALT SURFACE REMOVAL, 2"	SQ YD	304
58100200	WATERPROOFING MEMBRANE SYSTEM	SQ YD	464
* X4401198	HOT-MIX ASPHALT SURFACE REMOVAL, VARIABLE DEPTH	SQ YD	1,061
* X4420486	CLASS D PATCHES, TYPE IV, 6 INCH (SPECIAL)	SQ YD	31
* X7010216	TRAFFIC CONTROL AND PROTECTION, (SPECIAL)	L SUM	1

\* SEE SPECIAL PROVISIONS

ADDENDUM 1

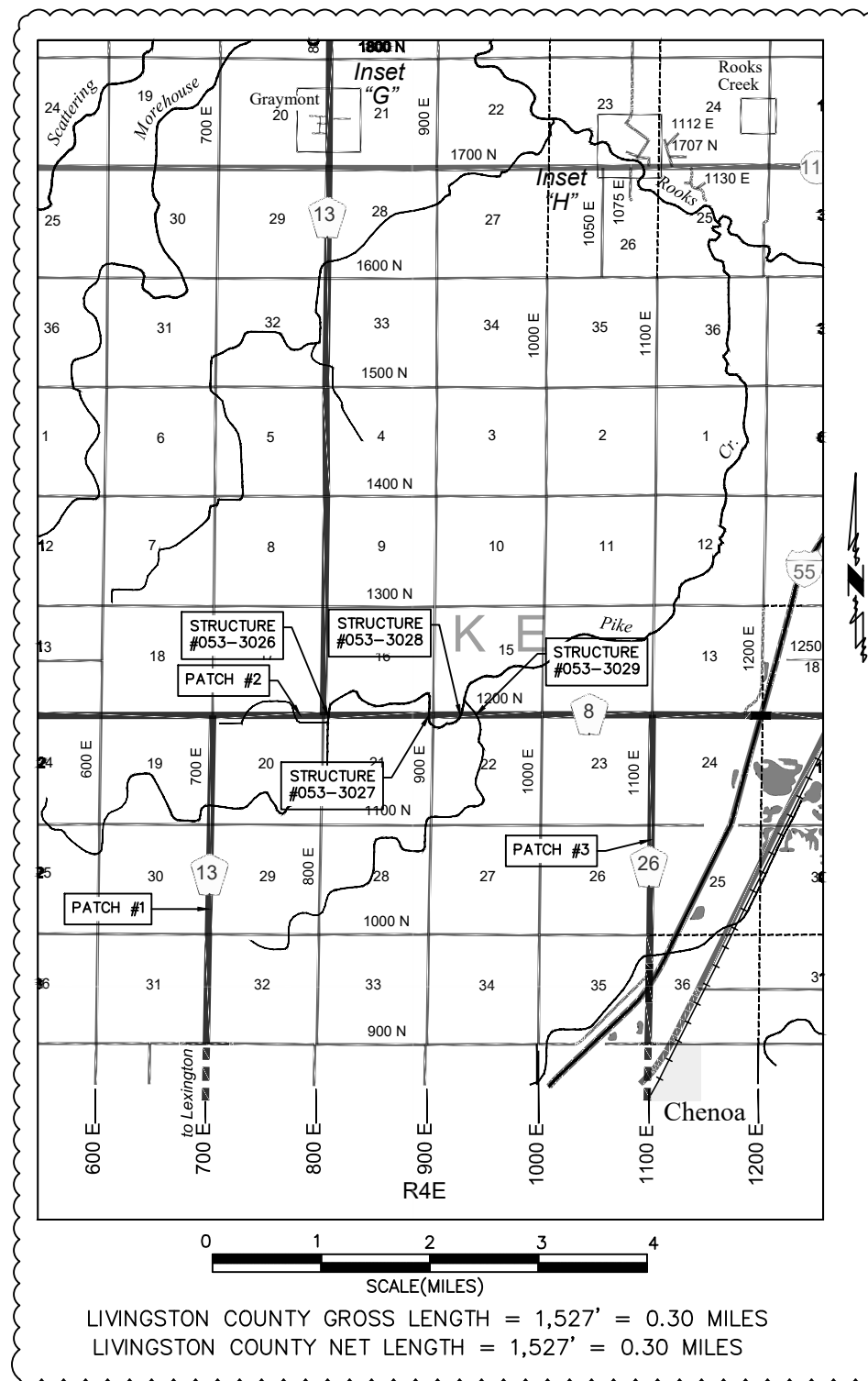

ADDENDUM 1

**LIVINGSTON COUNTY:** THIS PROJECT CONSISTS OF OVERLAYING EXISTING STRUCTURES ALONG CH 8 (1200N RD). INCLUDES THE OVERLAY OF STRUCTURES 053-3026, 053-3027, 053-3028 & 053-3029 LOCATED ALONG 1200N RD BETWEEN 800E RD AND 1000E RD & THREE HMA PATCHES ON 700E, 1200N & 1100E.

**UTILITIES**

CONTACT J.U.L.I.E. 811 or 800-892-0123 BEFORE DIGGING

**TRAFFIC DATA**

C.H. 8 - COLLECTOR  
POSTED SPEED = 55 MPH-RURAL  
DESIGN SPEED = 50 MPH-RURAL  
CURRENT ADT= 350  
CLASS III ROADS, 80,000#



THESE PLANS WERE MADE BY ME OR BY A MEMBER OF MY STAFF WORKING UNDER MY PERSONAL SUPERVISION.

05/05/2023  
DATE

TRENT RUESTMAN, P.E.  
NO. 062.068070  
EXPIRATION DATE 11/30/23

LIVINGSTON COUNTY GROSS LENGTH = 1,527' = 0.30 MILES  
LIVINGSTON COUNTY NET LENGTH = 1,527' = 0.30 MILES

CONTRACT NO. ----



LOCATION OF SECTION INDICATED THUS: - - - -

"THE ACCEPTANCE OF THIS PROJECT IS BASED ON THE MINIMUM DESIGN CRITERIA UNDER 3R GUIDELINES."

APPROVED 05/05 20 23

Clay Mitchell  
LIVINGSTON COUNTY OFFICIAL

PASSED 20

DISTRICT THREE LOCAL ROADS & STREETS ENGINEER

RELEASING FOR BID BASED ON LIMITED REVIEW 20

REGION TWO ENGINEER  
STATE OF ILLINOIS  
DEPARTMENT OF TRANSPORTATION

NOT PLOTTED TO SCALE

ROUTE NO.	SECTION	COUNTY	TOTAL SHEETS	SHEET NO.
1362	22-00100-04-SM	LIVINGSTON	3	2
PROJECT NO. ----		CONTRACT NO. ----		

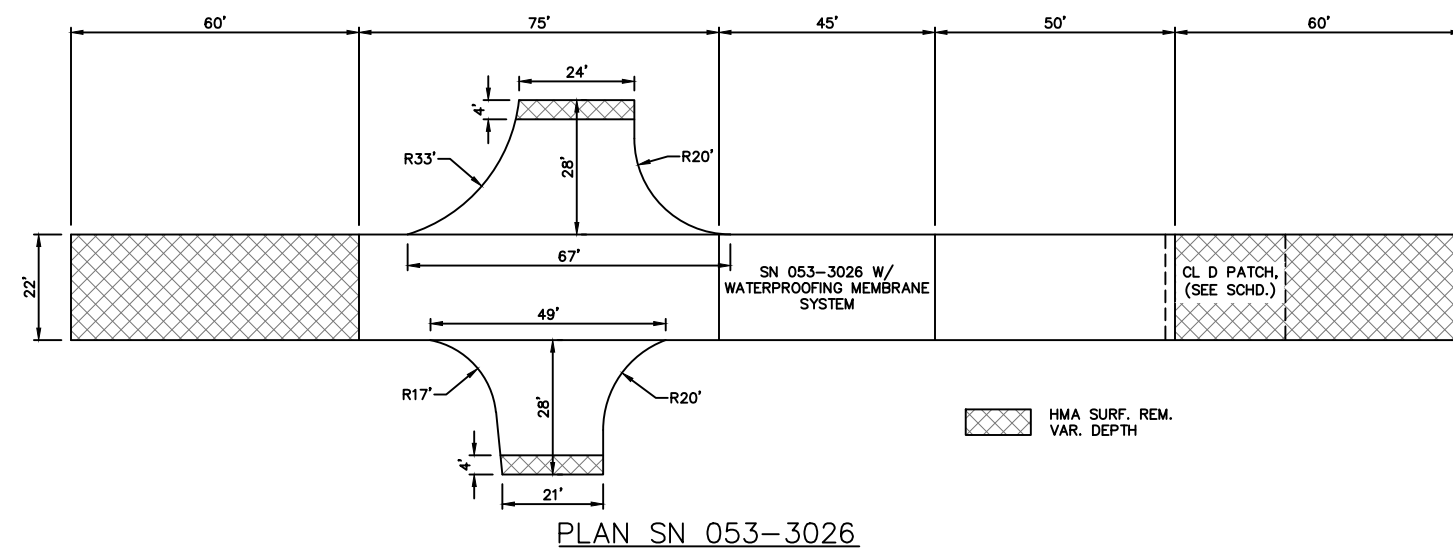

PLAN SN 053-3026

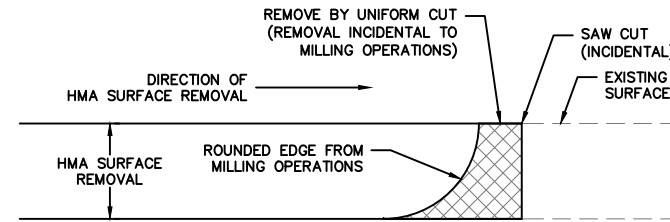

NOTE: WHEN MILLING OPERATIONS PRODUCE A ROUNDED EDGE, THEN A SAW CUT SHALL BE USED TO MANUFACTURE A PERPENDICULAR EDGE AS SHOWN IN THE DETAIL. THE ENGINEER SHALL BE THE SOLE JUDGE CONCERNING THE USE OF THIS DETAIL.

HMA DETAIL AT BUTT JOINTS

BITUMINOUS MIX TABLE

Mixture Use(s)	HMA Surface
Location(s)	ENTIRE PROJECT
PG Grade	PG64-22
Design Air Voids	4.0% @ N50
Mixture Composition	IL 9.5FG
Friction Aggregate	Mixture C
Density Test Method	Satisfaction of Engineer
Mixture Weight	112 # / s.y. / inch
Quality Management Program	QC/QA
Sublot Size	N/A
Material Transfer Device	NO

Sta.	Lane	LENGTH (FT)	WIDTH (FT)	AREA (SQ YD)
Sta. 478+80 to Sta. 479+05	WBL	25	11	31
TOTALS				31

LOCATION	AREA (SQ YD)	HMA SURF REM VAR DEPTH (S.Y.)	BIT. MAT. (TACK COAT) (LB)	SURFACE COURSE
800E (R)	105	11	47	9
800E (L)	82	9	37	7
900E (R)	98	10	44	8
900E (L)	99	10	45	8
PE Sta. 495+91 (R)	55	12	25	5
TOTALS		52	198	37

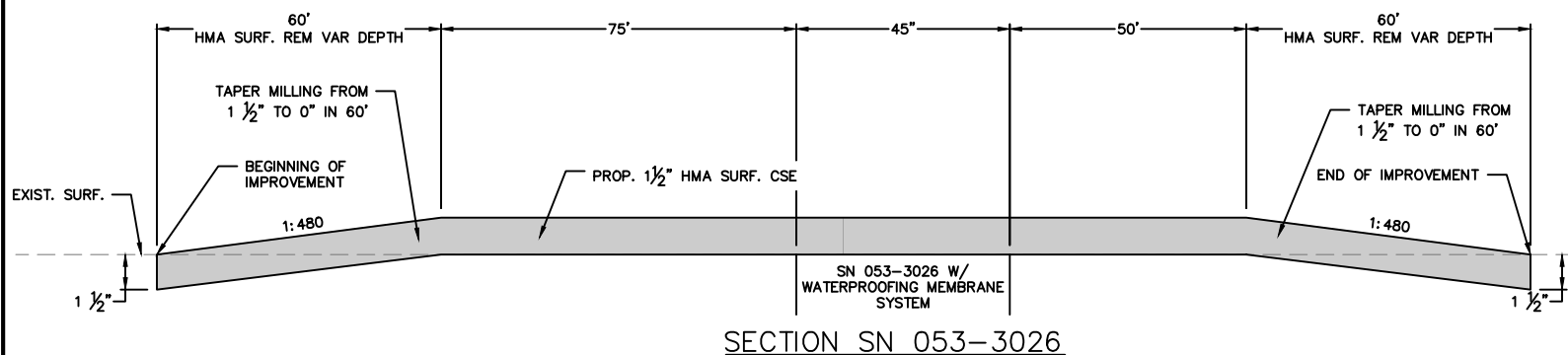

SECTION SN 053-3026

BEGINNING & END OF IMPROVEMENTS (NTS)

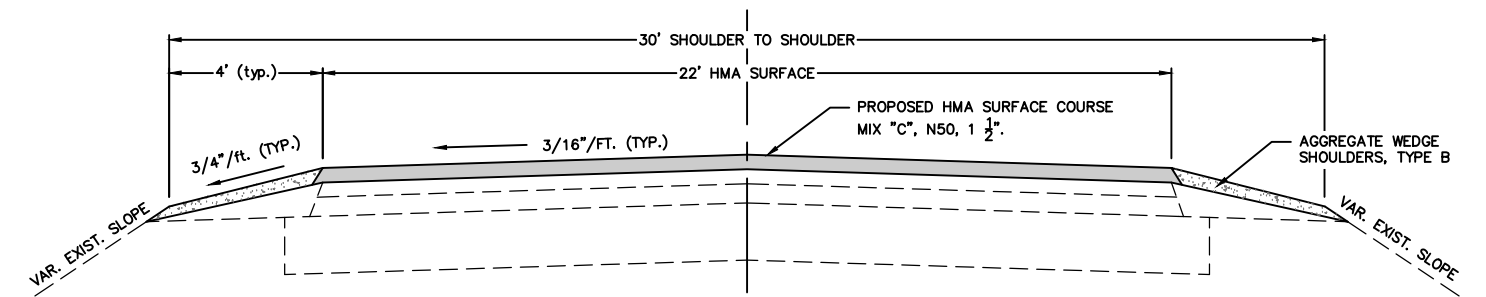

PROPOSED TYPICAL CROSS SECTION (NTS)

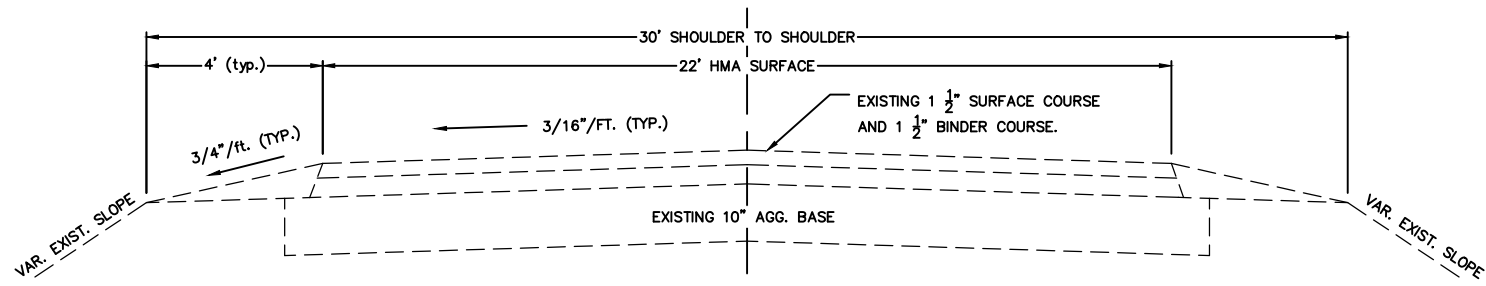

EXISTING TYPICAL CROSS SECTION (NTS)

ADDENDUM 1

SCHEDULE OF RESURFACING QUANTITIES

LOCATION (QUANTITY)	LENGTH	Paving width	HMA SURF REMOVAL VAR DEPTH (SQ YD)	WATERPROF MEMBRANE SYSTEM (SQ YD)	Unit weight Constant = 112.0 lbs./s.y./inch		
					BIT MATLS TACK CT (POUND)	HMA SURF REMOVAL 2" (SQ YD)	HMA SURF CSE "C" N50 (TON)
<b>MAINLINE</b>							
425+96.5 to 426+56.5 (TAPER)	60.0	22.0	147	-	66	-	12
426+56.5 to 427+31.5	75.0	22.0	-	-	82	-	15
427+31.5 to 427+76.5 (SN 053-3026)	45.0	24.0	-	120	27	-	10
427+76.5 to 428+26.5	50.0	22.0	-	-	55	-	10
428+26.5 to 428+86.5 (TAPER)	60.0	22.0	147	-	66	-	12
478+17.5 to 478+77.5 (TAPER)	60.0	22.0	147	-	66	-	12
478+77.5 to 479+27.5	50.0	22.0	-	-	55	-	10
479+27.5 to 479+72. (SN 053-3027)	44.5	24.0	-	119	27	-	10
479+72. to 480+84.	112.0	22.0	-	-	123	-	23
480+84. to 481+44. (TAPER)	60.0	22.0	147	-	66	-	12
492+99.1 to 493+59.1 (TAPER)	60.0	22.0	147	-	66	-	12
493+59.1 to 494+09.1	50.0	22.0	-	-	55	-	10
494+09.1 to 494+53.1 (SN 053-3028)	44.0	24.0	-	117	26	-	10
494+53.1 to 500+59.1	606.0	22.0	-	-	666	-	124
500+59.1 to 500+99.6 (SN 053-3029)	40.5	24.0	-	108	24	-	9
500+99.6 to 501+49.6	50.0	22.0	-	-	55	-	10
501+49.6 to 502+09.6 (TAPER)	60.0	22.0	147	-	66	-	12
PATCH #1 1015N, 700E RD	10.0	21.0	23	-	10	-	2
	25.0	21.0	-	-	26	-	5
	25.0	21.0	58	-	26	-	5
PATCH #2 779E, 1200N RD	238.0	11.5	-	-	137	304	34
PATCH #3 1083N, 1100E RD	10.0	21.0	23	-	10	-	2
	15.0	21.0	-	-	16	-	3
	10.0	21.0	23	-	10	-	2
TOTAL JOB LENGTH OR MAINLINE QUANTITY	1860		1009	464	1829	304	366
<b>MISCELLANEOUS</b>							
SIDEROAD INTERSECTIONS/ENTRANCES (3)	-		52	-	198	-	37
TOTALS OF MAINLINE & MISC.	1,860		1,061	464	2,027	304	403



Contractor's Name

Contractor's Address

City

State

Zip Code

Local Public Agency

County

Section Number

Route(s) (Street/Road Name)

**Schedule for Multiple Bids**

Combination Letter	Section Included in Combinations	Total

**Schedule for Single Bid**

(For complete information covering these items, see plans and specifications.)

Item Number	Items	Unit	Quantity	Unit Price	Total
40600290	BIT MATLS TACK CT	POUND	2027		
40604000	HMA SC IL-9.5FG C N50	TON	403		
44000157	HMA SURF REM 2	SQ YD	304		
58100200	WATERPRF MEMBRANE SYS	SQ YD	464		
X4401198	HMA SURF REM VAR DP	SQ YD	1061		
X4420486	CL D PATCH T4 6 SPL	SQ YD	31		
X7010216	TRAF CONT & PROT SPL	L SUM	1		
Bidder's Total Proposal					

1. Each pay item should have a unit price and a total price.
2. If no total price is shown or if there is a discrepancy between the product of the unit price multiplied by the quantity, the unit price shall govern.
3. If a unit price is omitted, the total price will be divided by the quantity in order to establish a unit price.
4. A bid may be declared unacceptable if neither a unit price or total price is shown.