

PDF#PIN: 010+10-10-07-300-005
 18375 E 2500 N RD, ODELL

Livingston County Supr of Assessments

Fri, 4/3/2015, 4:26 PM Page 1

Deed: MILLER KEVIN & GRUBER SUZIE
 Contract:
 CID#:
 DBA:
 MLS:

Map Area: Odell Twp-10
 Route: 000-000-000
 Tax Dist: 10001
 Plat Page:
 Subdiv: [NONE]

Checks/Tags: S
 Lister/Date:
 Review/Date:
 Entry Status: Inspected

Rural/Residential
 Legal: 10-07-300-005 S7 T29 R6 3.00 ACRES PT SW BEG 611.85' W SE COR N303' W432' S303' E432' TO POB

Land										
Land Basis	Front	Rear	Side 1	Side 2	R. Lot	SF	Acres	Depth	EFF	Qual./Land
Lump Sum						130,680.00	3.000			
Grand Total						130,680.00	3.000			

Street		Utilities		Zoning		Land Use	
Lump Sum	None	None	None	Not Applicable	Not Applicable	Not Applicable	Not Applicable

Sales										Building Permits			Values	
Date	\$ Amount	NUTC	Recording	Date	Number	Tag	\$ Amount	Reason	Type	S/A	Prior Yr: 2011			
11/24/2014	\$160,000	D000	631798						N/F Lnd	\$8,990	\$8,752			
05/10/1998	\$45,000	D000	500889						N/F Bld	\$37,251	\$35,981			
04/13/1998	\$35,000	D000	500006						Land		\$0			
									Bldg		\$0			
									Total	\$46,141	\$44,733			

Res. Structure		Finish				Plumbing				Addition				Garage		
Occ. Code	101	Tl Rooms Above #	7	Bedrooms Above #	4	Full Bath		Addition	1 of 1	Garage	1 of 1					
Occ. Descr.	Single-Family / Owner Occupied	Tl Rooms Below #	0	Bedrooms Below #	0	Shower Stall Bath		Year Built	1910	Style	Det Brick					
Year Built	1910	Bsmt Fin Area #1				Toilet Room		EFA	100	WxL	24' X 16'					
EFA/EFYr	106 / 1910	Bsmt Fin Area #2				Lavatory		EFA Year	1910	Area (SF)	384					
Arch. Dsgn	N/A	Bsmt Fin Area #3				Water Closet		Style	1 Sty Frm	Year Built	1940					
Style	1 1/2 Story Frame	Foundation	Conc			Sink		Area (SF)	448	EFA	76					
AreaSF/TLA	392 / 1,114	Exterior Walls	Vinyl			Shower Stall/Tub		Condition	Very Good	EFF Year	1940					
GLA 1st/2nd	840 / 274	Roof	Sh / Asph			Laundry Sink		Bsmt (SF)	448	Condition	NML					
		Interior Finish	Plas			Mtl Stall Shower		NoBsmt Flr(SF)		Bsmt (SF)						
		Flooring	Wood			Whirlpool Bathroom		Heat	Yes	Ctrs Over	None					
		Non-base Heating		Fireplace		Whirlpool Tub		AC	No	Ctrs Over (SF)						
		Floor/Wall #	0			Hot Water Heater		Attic (SF)		Ctrs AC (SF)						
		Pipeless #	0			Wet Bar				Door Opnrs						
		Hand Fired (Y/N)	No			No Bathroom				Bsmt Stalls						
		Space Heat #	0			No Plumbing										
		Appliances				No Hot Water Tank										
		Range Unit	Built-In Vacuums			Water Only w/Sink										
		Oven - Single	Intercom System			Hot Tub										
		Oven - Double	BI Stereo(SpkrsOnly)			Bidet										
		Dishwasher				Fbgls Service Sink										
		Microwave				Urinal										
		Trash Compactor				Sauna										
		Jennair				W'Pool Bath w/Shower										
		Security System				[EMPTY]										
						[EMPTY]										



PDF+PIN: 010+10-10-07-300-005

Bldg / Assn	Description	Units	Year						
1 of 1	101 -- Single-Family / Owner Occupied	392							
	1 1/2 Story Frame								
	Base Heat: FHA - Gas								
#1	Porch: 1S Frame Enclosed	30 SF							
#2	Porch: 1S Frame Enclosed	108 SF			1910				
1 of 1	Adtn 1 Story Frame	448 SF							
	Basement area	448 SF			1940				
	Garage: Det Brick	24' X 16'	384 SF						

		Description	Units	Cond	Year				
P.0	Yrd I	1 — BLK GARAGE Width=30, Length=20, Quantity=600		OBSV	1930				

Prior Year	Comment	Value Type	Location	Class	Farm Land	Farm Building	NF Land	NF Building	Total Value
2011	VAI (pre 08 manual convert)	BoFR			\$0	\$0	\$8,752	\$35,981	\$44,733

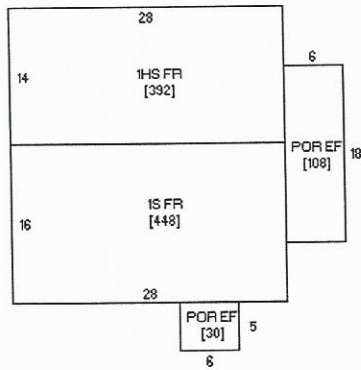

Sketch 1 of 1

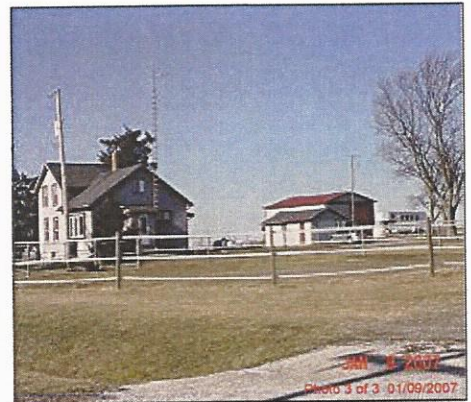

Notes:

PRERMIT I-81-98 NEW HORSE BARN COMP 7/98 - ASSESSED FOR 1/2 OF 1998. 1974 GRAIN BIN ON THIS PARCEL IN ERROR, S/B ON 10-07-300-004 - CORRECTED FOR 2005. BARN, CATTLE SHED & 28 X 104 SHED REMOVED FOR 2005 PER ASSESSOR.