

10725 E 1700 N RD, PONTIAC

Deed: MINNAERT KALE & MARSHALL JODI
 Contract:
 CID#:
 DBA:
 MLS:

Map Area: Rooks Creek Twp
 Route: 000-000-000
 Tax Dist: 14002
 Plat Page:
 Subdiv: [NONE]

Checks/Tags:
 Lister/Date:
 Review/Date:
 Entry Status:

Rural/Residential

Legal: 14-23-452-004 2.69 ACRES LOTS 7 & 8 JOHNSON ACRES SUB

Land											
Land Basis	Front	Rear	Side 1	Side 2	R. Lot	SF	Acres	Depth	EFF	Qual./Land	
Lump Sum						117,176.40	2.690				
Grand Total						117,176.40	2.690				

Street		Utilities		Zoning		Land Use	
Lump Sum	None	None	None	Not Applicable	Not Applicable	Not Applicable	Not Applicable

Sales			Building Permits			Values					
Date	\$ Amount	NUTC	Recording	Date	Number	Tag	\$ Amount	Reason	Type	S/A	
02/26/2014	\$159,000	D000	627977						N/F Lnd	\$16,098	\$48,299
12/22/2009	\$105,000	D043	599057						N/F Bld	\$18,999	\$57,003
									Land		\$0
									Bldg		\$0
									Total	\$35,097	\$105,302

Res. Structure		Finish		Plumbing		Addition		Garage	
Occ. Code	101	Tl Rooms Above #	6	Bedrooms Above #	4	Full Bath	1	Addition	1 of 1
Occ. Descr.	Single-Family / Owner Occupied	Tl Rooms Below #	0	Bedrooms Below #	0	Shower Stall Bath		Year Built	1910
Year Built	1910	Bsmt Fin Area #1				Toilet Room	1	EFA	106
EFA / EFYr	106 / 1910	Bsmt Fin Area #2				Lavatory		EFA Year	1910
Arch. Dsgn	N/A	Bsmt Fin Area #3				Water Closet		Style	1 Sty Frm
Style	1 1/2 Story Frame	Foundation	Conc			Sink		Area (SF)	140
AreaSF/TLA	728 / 1,378	Exterior Walls	Wd Lap			Shower Stall/Tub		Condition	Normal
GLA 1st/2nd	868 / 510	Roof	Sh / Asb			Laundry Sink		Bsmt (SF)	140
		Interior Finish	Plas			Mtl Stall Shower		NoBsmt Flr(SF)	
		Flooring	Wood			Whirlpool Bathroom		Heat	Yes
		Non-base Heating		Fireplace		Whirlpool Tub		AC	No
		Floor/Wall #	0			Hot Water Heater		Attic (SF)	
		Pipeless #	0			Wet Bar			
		Hand Fired (Y/N)	No			No Bathroom			
Condition	EXCEL	Space Heat #	0			No Plumbing			
		Appliances				No Hot Water Tank			
Basement	1/2	Range Unit		Built-In Vacuums		Water Only w/Sink			
No Bsmt Fir.	0	Oven - Single		Intercom System		Hot Tub			
Heat	HW - Radiant	Oven - Double		BI Stereo(SpkrOnly)		Bidet			
AC	No	Dishwasher				FbglS Service Sink			
Attic	None	Microwave				Urinal			
		Trash Compactor				Sauna			
		Jennair				W'Pool Bath w/Shower			
		Security System				[EMPTY]			
						[EMPTY]			

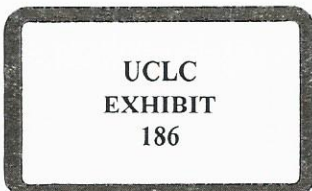

Bldg / Adtn	Description	Units	Year						
1 of 1	101 — Single-Family / Owner Occupied								
	1 1/2 Story Frame	728							
	Adjustment for basement - 1/2								
	Base Heat: HW - Radiant								
#1	Porch: 1S Brick Open	96 SF							
	Plumbing	2							
1 of 1	Adtn 1 Story Frame	140 SF	1910						
	Basement area	140 SF							

	Description	Units	Cond	Year									
P:0	Yrd 1 — MILK HOUSE Width=10, Length=10, Quantity=100		OBSV	1910									
P:0	Yrd 1 — SHED Width=40, Length=30, Quantity=1200		OBSV	1910									
P:0	Yrd 1 — CRIB Width=32, Length=32, Quantity=1024		OBSV	1900									

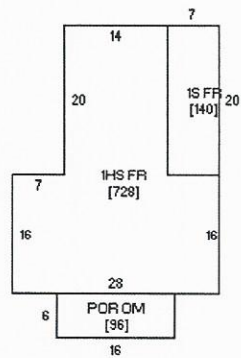



Notes:

REASSESSED FOR 1999. CRIB REMOVED FOR 2003 PER OWNER.
CHANGED CONDITION TO EXCELLENT FOR THE 2015 ASSESSMENT YEAR PER DCK.