

29227 N 2300 E RD, ODELL

Deed: QUIROZ PEDRO & ALEJANDRA

Map Area: Nevada Twp-04

Checks/Tags: S

Contract:

Route: 000-000-000

Lister/Date:

CID#:

Tax Dist: 04007

Review/Date:

DBA:

Plat Page:

Entry Status: Inspected

MLS:

Subdiv: [NONE]

Rural/Ag Improved

Legal: 04 23 400 003 S23 T30 R6 5.00 ACRES BEG SE COR SE N876.45' POB W467.1' N466.7' E467.1' S466.7'

Land												
Land Basis	Front	Rear	Side 1	Side 2	R. Lot	SF	Acres	Depth	EFF	Qual./Land		
Lump Sum						67,518.00	1.550					
Ag Land						150,282.00	3.450					
Grand Total						217,800.00	5.000					
Street			Utilities			Zoning			Land Use			
Lump Sum	None		None			Not Applicable			Not Applicable			
Ag Land	None		None			Not Applicable			Not Applicable			
Sales				Building Permits				Values				
Date	\$ Amount	NUTC	Recording	Date	Number	Tag	\$ Amount	Reason	Type	S/A	Prior Yr. 2011	
12/19/2013	\$118,000	D052	626869						N/F Lnd	\$5,749	\$5,744	
03/01/2007	\$35,000	D017	577823						N/F Bld	\$18,504	\$17,654	
12/30/1972	\$11,000	D052	327-786						Land	\$391	\$314	
									Bldg	\$688	\$458	
									Total	\$25,332	\$24,170	

**UCLC
EXHIBIT
184**

Res. Structure		Finish		Plumbing		Addition		Garage			
Occ. Code	101	Tl Rooms Above #	5	Bedrooms Above #	3	Full Bath	1	Addition	1 of 2	Garage	No garages
Occ. Descr.	Single-Family / Owner Occupied	Tl Rooms Below #	0	Bedrooms Below #	0	Shower Stall Bath		Year Built	2009	Style	
Year Built	1910	Bsmt Fin Area #1				Toilet Room		EFA	3	WXL	
EFA / EFYr	102 / 1910	Bsmt Fin Area #2				Lavatory		EFA Year	2009	Area (SF)	
Arch. Dsgn	N/A	Bsmt Fin Area #3				Water Closet		Style	1 Sty Frm	Year Built	
Style	1 Story Frame	Foundation	Conc			Sink		Area (SF)	152	EFA	
AreaSF/TLA	879 / 1,095	Exterior Walls	Wd Lap			Shower Stall/Tub		Condition	Normal	EFF Year	
GLA 1st/2nd	1,095 / 0	Roof	Sh / Asph			Laundry Sink		Bsmt (SF)		Condition	
		Interior Finish	Plas			Mtl Stall Shower		NoBsmt Flr(SF)		Bsmt (SF)	
		Flooring	Wood			Whirlpool Bathroom		Heat	FHA - Gas	Ctrs Cver	
		Non-base Heating		Fireplace		Whirlpool Tub		AC	No	Ctrs Cver (SF)	
		Floor/Wall #	0			Hot Water Heater		Attic (SF)		Ctrs AC (SF)	
		Pipeless #	0			Wet Bar		See other pages for more additions.			
		Hand Fired (Y/N)	No			No Bathroom				Door Opnrs	
		Space Heat #	0			No Plumbing				Bsmt Stalls	
		Appliances				No Hot Water Tank					
Basement	1/2	Range Unit		Built-In Vacuums		Water Only w/Sink					
No Bsmt Flr.	0	Oven - Single		Intercom System		Hot Tub					
Heat	FHA - Gas	Oven - Double		BI Stereo(SpkrsOnly)		Bidet					
AC	No	Dishwasher				Fbgls Service Sink					
Attic	None	Microwave				Urinal					
		Trash Compactor				Sauna					
		Jennair				W'Pool Bath w/Shower					
		Security System				[EMPTY]					
						[EMPTY]					



Bldg / Adtn	Description	Units	Year						
1 of 1	101 — Single-Family / Owner Occupied								
	1 Story Frame	879							
	Adjustment for basement - 1/2								
	Base Heat: FHA - Gas								
#1	Porch: 1S Frame Enclosed	160 SF							
	Deck #1: Wood Deck-Med	192 SF							
1 of 2	Adtn 1 Story Frame	152 SF	2009						
2 of 2	Adtn 1 Story Frame	64 SF	2009						

Prior Year	Comment	Value Type	Location	Class	Farm Land	Farm Building	NF Land	NF Building	Total Value
2011	VAI (pre 08 manual convert)	BofR			\$314	\$458	\$5,744	\$17,654	\$24,170

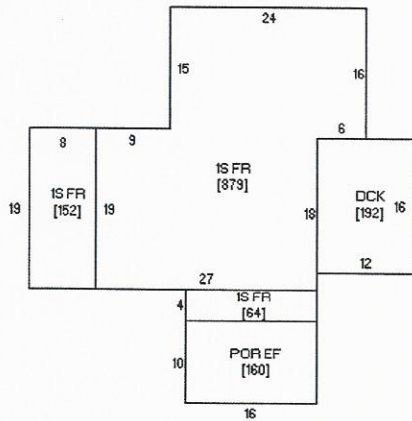

Sketch 1 of 1



PDF+PIN: 004+04-04-23-400-003

Wed, 3/11/2015, 9:39 AM Page 7

Notes:

REASSESSED FOR 1999. BARN & LEAN-TO REMOVED FOR 2007 PER T/A. 9 X 11 PT OF HOUSE REMOVED, 2 NEW ADDITIONS 50% COMP 1/09 - ASSESSED AT 50% FOR 2009 PER T/A (NO PERMIT). 14 X 16 ADD SHOULD PARTIALLY BE AN EFP & 8 X 19 ADD ONLY 50% COMP FOR 2010 - VALUE ADJ FOR 2010 PER T/A.