

PDF#PIN: 022+22-22-25-300-008
 10322 N 2315 E RD, FAIRBURY

Livingston County Supr of Assessments

Fri, 4/3/2015, 4:32 PM Page 1

Deed: MEISS KEVIN R & MAYE K
 Contract:
 CID#:
 DBA:
 MLS:

Map Area: Avoca Twp
 Route: 000-000-000
 Tax Dist: 22007
 Plat Page:
 Subdiv: [NONE]

Checks/Tags:
 Lister/Date:
 Review/Date:
 Entry Status: Inspected

Rural/Ag Improved

Legal: 22-25-300-008 S25 T27 R6 5.99 ACRES PT LOT 9 BEG 1920 N & 280.5 E SW COR SE408.22 NE286.83 NE285.63 NE165.79 N225.6 W816.15 TO POB POPEJOY'S LAND

Land												
Land Basis	Front	Rear	Side 1	Side 2	R. Lot	SF	Acres	Depth	EFF	Qual./Land		
Lump Sum						41,817.60	0.960					
Ag Land						219,106.80	5.030					
Grand Total						260,924.40	5.990					

Street		Utilities		Zoning		Land Use	
Lump Sum	None	None	None	Not Applicable	Not Applicable	Not Applicable	Not Applicable
Ag Land	None	None	None	Not Applicable	Not Applicable	Not Applicable	Not Applicable

Sales				Building Permits				Values			
Date	\$ Amount	NUTC	Recording	Date	Number	Tag	\$ Amount	Reason	Type	S/A	Prior Yr: 2011
03/30/2009	\$272,500	D052	593233	6/21/2001	I-96-01	N	\$160,000	New Dwlg	N/F Lnd	\$3,993	\$3,673
12/15/1999	\$20,000	D034	514669						N/F Bld	\$70,733	\$70,332
									Land	\$576	\$471
									Bldg	\$5,500	\$5,277
									Total	\$80,802	\$79,753



Res. Structure		1 of 1		Finish				Plumbing		Addition		Garage	
Occ. Code	101	Tl Rooms Above #	0	Bedrooms Above #	3	Full Bath	3	Addition	No Additions	Garage	1 of 1		
Occ. Descr.	Single-Family / Owner Occupied	Tl Rooms Below #	0	Bedrooms Below #	0	Shower Stall Bath		Year Built		Style	Att Frm		
Year Built	2002	Bsmt.Fin Area #1				Toilet Room		EFA		WXL	0' X 0'		
EFA / EFYr	14 / 2002	Bsmt.Fin Area #2				Lavatory		EFA Year		Area (SF)	580		
Arch. Dsgn	N/A	Bsmt.Fin Area #3				Water Closet		Style		Year Built	2002		
Style	1 Story Frame	Foundation	Conc			Sink	1	Area (SF)		EFA	14		
AreaSF/TLA	1,983 / 1,983	Exterior Walls	Vinyl			Shower Stall/Tub		Condition		EFF Year	2002		
GLA 1st/2nd	1,983 / 0	Roof	Sh / Asph			Laundry Sink				Condition	NML		
Condition	NML	Interior Finish	Drwl			Mtl Stall Shower		Bsmt (SF)		Bsmt (SF)			
Basement	3/4	Flooring	Carp			Whirlpool Bathroom		NoBsmt Flr(SF)		Ctrs Over	None		
No Bsmt Flr.	0	Non-base Heating		Fireplace		Whirlpool Tub		Heat		Ctrs Over (SF)			
Heat	Yes	Floor/Wall #	0	Prefab, 1 Sty	1	Hot Water Heater		AC		Ctrs AC (SF)			
AC	Yes	Pipeless #	0			Wet Bar		Attic (SF)		Door Opnrs			
Attic	None	Hand Fired (Y/N)	No			No Bathroom				Bsmt Stalls			
		Space Heat #	0			No Plumbing							
						No Hot Water Tank							
		Appliances				Water Only w/Sink							
		Range Unit		Built-In Vacuums		Hot Tub							
		Oven - Single		Intercom System		Bidet							
		Oven - Double		BI Stereo(SpkrsOnly)		Fbgls Service Sink							
		Dishwasher				Urinal							
		Microwave				Sauna							
		Trash Compactor				W'Pool Bath w/Shower							
		Jennair				[EMPTY]							
		Security System				[EMPTY]							



Bldg / Addn	Description	Units	Year						
1 of 1	101 — Single-Family / Owner Occupied								
	1 Story Frame	1,983							
	Base Heat								
	Add Central Air	1,983							
#1	Porch: 1S Brick Open	225 SF							
#2	Porch: 1S Frame Screen	280 SF							
	Deck #1: Wood Deck-Med	336 SF							
	Plumbing	4							
#1	Fireplace: Prefab, 1 Story	1							
	Garage: Att Frame	580 SF		2002					

Prior Year	Comment	Value Type	Location	Class	Farm Land	Farm Building	NF Land	NF Building	Total Value
2011	VAI (pre 08 manual convert)	BofR			\$471	\$5,277	\$3,673	\$70,332	\$79,753

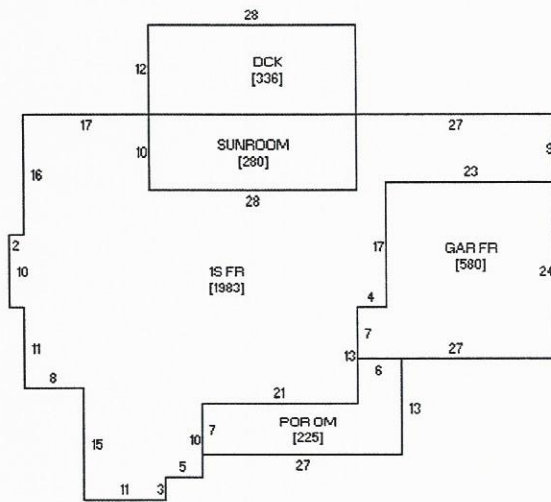

Sketch 1 of 1



Notes:

PERMIT I-139-00 NEW SHELTER (4 SIDES OPEN) COMP 5/01. PERMIT I-235-00 NEW POLE BLDG COMP 5/01 - BOTH ASSESSED FOR 8 MO OF 2001. PERMIT I-96-01 NEW HOUSE COMP 1/02.
SOME OF INTERIOR DATA FROM
HOUSE PLANS RECORDED IN ZONING OFFICE.